

Construction Specifications

BUILDER

Sterling Construction Inc.
1037 Hinesburg Rd
South Burlington, VT 05403

Plan:

Triplex Chestnut

Plan Date:

12/5/2014

Specifications:

Chestnut Spec

Specifications Date:

12/8/2014



HOME OWNERS

Chestnut Duplex Model

PROJECT ADDRESS

South Village Lot 45-L
119 South Jefferson Rd
South Burlington, VT 05403



DESCRIPTION

Triplex Chestnut Plan: two story New England style duplex home with un-finished Lower Level. Two floors of finished area with approximately 1806 square feet of living space including first floor master suite; 1176 square feet of unfinished Lower Level, 440 square foot 2-car garage, 132 square foot front porch and 144 square foot deck.

SPECIFICATIONS INDEX

Section 1: Permits	Section 7: Cabinets & Countertops
Section 2: Structural Detail and Exterior Selections	Section 8: Wall & Trim Interior Detail Work
Section 3: Electrical Rough In Details and Specifications	Section 9: Flooring and Paint Selections
Section 4: Lighting	Section 10: Appliances
Section 5: Plumbing	Section 11: Landscaping
Section 6: Fireplace & Mantle	Section 12: Site Work and Preparation
	Section 13: Miscellaneous

CHANGE ORDERS

<u>C/O Number</u>	<u>C/O code</u>	<u>C/O Date</u>	<u>Plan Date</u>
#O&S	1/19/2015	1/19/2015	12/8/2015
~Updated Carpet	4/13/2015	4/12/2015	12/8/2015

PERMITS

PERMITS:

Builder responsible to obtain all necessary permits including.
Building permits

STRUCTURE DETAIL & EXTERIOR SELECTIONS

FOUNDATIONS/LOWER LEVEL:

Type:	Poured Concrete
Wall Height:	9'-0"
Lookout Height:	4' Frost Wall
Strength:	Min. 3000 PSI @ 28 days with steel reinforcement
Footer:	Continuous 8" x 24" Reinforced
Sealer:	Dampproofing applied below grade

FLAT WORK CONCRETE:

Lower Level:	Poured concrete.
Finish	Smooth
"Keyway" joints:	Saw Cut
Thickness:	4"
Strength:	House: Min. 3000 PSI @ 28 days Garage: Min. 4000 PSI @ 28 days
Moisture Barrier:	Perimeter tile buried to outside.
Ground water controls:	Stone and tile on outside drained to daylight

FRAME:

Exterior walls:	2x6 SPF 24" o.c.
Interior walls:	2x4 SPF 24" o.c.
Plate height:	9'-1" on first floor; 8'-1" on the second floor and 9'-0" in Lower Level.
Plate:	2x6 treated Southern Yellow Pine with foam sill seal.
Floor Framing:	11-7/8" Truss Joist TJI 230 Series I-joists @ 24" o.c.
Sub Flooring:	3/4" 4x8 T&G OSB Advantech glued and nailed.
Girders:	2 or 3 ply Trus Joist Microllam LVL, nailed and glued, as specified by engineering load design, supported by 3-1/2" concrete filled lally columns in Lower Level
Sheathing:	7/16" 4x8 OSB
Roof:	Pre-engineered roof trusses 24" o.c. 5/8" T&G OSB rated sheathing
House wrap:	Pitches: 5/12 and 10/12 at Main House; 5/12 at Garage; 4.5/12 at Front Porch Professional house wrap with flashing around all windows and doors.

SPECIAL FRAMING: None

ROOFING:

CertainTeed Landmark shingles Ice and water shield on eaves and valleys.
 Vented on ridge to achieve proper ventilation.
 Shingles: CertainTeed Landmark- Limited Lifetime Warrantee
 Color: #Colonial Slate

SIDING:

Mitten Highland Panel
 Vinyl Shakes Color to be #Mocha
 Clapboard: Double 4" Color to be #Hearthstone.
 Board-and-Baton: None.
 Eaves: Two piece aluminum wrapped-White
 Soffit: Perforated Soffit for proper venting, Color to be White
 Corners: 6" White Vinyl Corners with Foam Backer
 Trim details: Frieze board and Garage Door trim to be Miratech
 Drip Edge: Galvanized
 Gutters & downspouts. White Seamless Gutters
 Shutters: Available as an option

WINDOWS:

Brand: Jeld-Wen New Construction Double Hung Window
 Construction: All- Vinyl, energy star qualified, argon-filled, low-E insulated double-pane windows.
 Maximum U-factor 32. Flat exterior casing with built-in J and nailing flange
 EZ-Tilt cleaning. Screens included. Properly flashed.
 Grills: Grills Between Glass 2 over 2
 Screens: Fiberglass mesh.

Window Schedule

LETTER	LOCATION	SIZE	TYPE	QTY.	Notes
A	Living Room	3465	Dbl. Hung	3	
B	MBR & BR3	3453	Dbl. Hung	3	
C	Master Bath & Bath 2	3441	Dbl. Hung	2	
D	Powder	2430	Awning	1	
E	BR2 & BR3	3453	Casement	3	
EG	Lower Level	6048	Slider	1	Egress
G	Lower Level	3624	Awning	1	
H2	MBR	6853	Slider	1	Egress
J	Stairwell	3418	Awning	1	

EXTERIOR DOORS:

Brand: Therma-Tru Insulated Fiberglass Doors
 Construction: Insulated fiberglass exterior doors with full weather stripping and adjustable sills. 6-9/16" jambs w/ 5/4x4 exterior trim. All exterior doors to have deadbolt locks. Door knobs and deadbolts keyed alike.
 All locksets/deadbolts to be EZ-Set satin nickel finish. A "jam-sill" weather pan will be installed at the threshold of all exterior doors with the exception of the garage to mudroom door.
 Screen Doors: None

Door Schedule

LETTER	LOCATION	SIZE	TYPE	QTY.	HARDWARE
I	Foyer Entry LH	3' - 0"	6 Panel	1	Double Bore
	S210 6 panel w/12" Single Sidelight				
II	Garage Entry LH	3' - 0"	6 Panel	1	Double Bore
	S210 6 Panel Solid				
III	Dining to Future Deck	6' - 0"	Slider	1	
	Jeld-Wen Vinyl Sliding Patio Door				



Entry Door I



Garage II



Dining to Deck III

OVERHEAD GARAGE DOOR:

Door: Insulated 16' x 7' Garage Door
 Design: Contemporary Flat Panel
 Color: Painted to match siding
 Car Opener: Yes - 2
 8" Lift master 1/2 Horsepower Electric opener
 Keyless Entry Punch Pad included



DECKS & PORCHES

Porch Framing: 6' x 22' Front Porch framed with PT 2x8 joists and 5/4x6 Cedar Decking. Miratech wrapped and painted PT 6x6 Posts and 2x10 roof beams
 Roof to be truss framed, roof shingles to match house.
 Porch ceiling to be vinyl bead board. Stairs from porch to walkway to be PT box steps with 5/4x6 Cedar treads

Porch Finish: Porch Deck, Rim and Stairs to be stained with TWP Total Wood Preservative, Color to be #Rustic 1516. Posts, Rails, and Roof Beams to be painted White.

Porch Rail: Pressure Treated rail and balusters
 Color: White

Side Deck/Patio: 12' x 12' deck framed with PT 2x10 joists and 5/4x6 Cedar Decking
 Access to deck from Dining Room. Steps from deck to side yard to be PT box stairs with 5/4x6 Cedar treads.

Rear Deck Finish: Decking and rim board to be stained with TWP Total Wood Preservative, Color to be #Rustic 1516.

Rear Deck Railing: Pressure Treated rail and balusters
 Color: White



ELECTRICAL ROUGH IN DETAILS AND SPECIFICATIONS

ELECTRICAL & LOW VOLTAGE:

Plugs/Switches: Underground service, 150 AMP panel.

Switches/Plugs
 Switch Style Toggle
 Plate Style
 Switch Color White

Dimmers
 Dimmer Style Lutron Skylark
 Dimmer Color White
 Dimmer Locations Per Electrical Plan
 Exterior plugs Per Electrical Plan



Lighting:
 Lighting fixtures: See Lighting section.
 Recessed lights

Miscellaneous Electrical:

Door chime Nutone: One 2-note, white door chime, Model BK125LWH
 Smoke/CO detectors 1 CO/Smoke per floor (3 total), 1 Smoke per bedroom (3 total)
 Bath vents Included, 110cfm vented to outside, programmable controls, fan w/light.
 Security System None.
 Central Vacuum Rough in only, 1 outlet per floor
 CAT 5 (data/phone) Yes, per electrical plan
 TV Jacks: 4 Per electrical plan.
 Audio: No.



LIGHTING

LIGHT FIXTURES:

All light selections will be done by South Village which will include 80% fluorescent fixtures as part of the Energy Efficiency Program. Lights can be adjusted by owner.

Ceiling Light Fixtures

**#Master Bedroom
#206759**



**#Master Bath
#951384**



**#Foyer Light
#360531**



**#Kitchen Sink/Island
#922544**



**#Deck/Garage Exterior
#397626**



**#Master Bedroom
#206759**



**#Main Bath
#951381**



**#Living Room
#216906**



**#Dining Room
#922571**



**#Upstairs Hall/Laundry
#216911**



**#Powder Room
#536913**



**#Master Closet
#299827**



**#Stairs (2)
#291430**



GAS

Main Kitchen Range	Yes
Main Fireplace	Yes
First Floor Dryer	Yes
Boiler	N/A
Hot water system	Yes
Grill Line at Deck	N/A

HEATING

Furnace Brand:	York LX Series, TM9V
Boiler Size:	60,000 BTU
Efficiency Rating:	96.0%
Zones:	Zone 1: 1st floor, Zone 2: 2nd floor.
Air Conditioner:	No A/C installed.
Thermostat:	1ea. Per finished floor
Bath venting:	Bath fans
Dryer venting	Per plan.

PLUMBING FIXTURES:

Kitchen:

Sink

Model:	11406-NA
Description:	Sterling McAllister Double Bowl Undermount Sink
Color:	Stainless Steel
Size	32" L x 18" W, 8" deep
Strainer:	Dearborn Stainless Basket Strainer

Faucet

Model:	K-596-VS
Description:	Kohler Simplice with Spray
Color:	Vibrant Stainless
Option:	Metal Strainers

Disposal

Model:	1/2 HP Insinkerator Badger 5
--------	------------------------------



Master Bath

2 Lavatory Faucets

Model: K-15241-4-CP
Description: Kohler Coralais Centerset Lavatory Faucet
Color: Polished Chrome

Shower

Model: 72230100
Description: Sterling Ensemble 60" Shower, Curve Wall
Color: White

Shower Trim:

Model: K-10240-CP 1.75gpm Shower Head
K-T15621-4-CP Valve Trim
Description: Kohler Forte/Coralais
Color: Polished Chrome

Toilet:

Model: 402082
Description: Sterling Windham Elongated Toilet Bowl
Size: 29"L x 16"W x 30"H
Color: White



Bath #2

Lavatory Faucet

Model: K-15241-4-CP
Description: Kohler Coralais Centerset Lavatory Faucet
Color: Polished Chrome

Tub/Shower:

Model: 71220120
Description: Sterling 60" Ensemble Curved Wall Tub/Shower
Color: White

Tub/Shower Trim:

Model: K-10240-CP 1.75gpm Shower Head
K-T15601-4-CP Valve Trim
Description: Kohler Forte/Coralais
Color: Polished Chrome

Toilet:

Model: 402082
Description: Sterling Windham Elongated Toilet Bowl
Size: 29"L x 16"W x 30"H
Color: White



Powder Room: (1/2 Bath)

Faucet

Model: K-15241-4-CP
Description: Kohler Coralais Centerset Lavatory Faucet
Color: Polished Chrome

Toilet:

Model: 402082
Description: Sterling Windham Elongated Toilet Bowl
Size: 29"L x 16"W x 30"H
Color: White

Sink

Model: K-2293-4-0
Description: Kohler Wellworth Pedestal
Color: White



Miscellaneous Plumbing

Outdoor Faucets: 2 Frost-Free Hose Bibs, located at back of the main house and one on the side of the front porch.
Hot Water Heater: Rinnai R-75LS1 Lp Continuum Instantaneous water heater
Laundry: Washer Box Valve with single handle shutoff
Laundry appliances pricing optional

PVC drainage plumbing. PEX continuous piping for all domestic water. All plumbing installed according to National Plumbing Code by licensed plumber.

Radon piping runs from under Lower Level concrete slab through roof. This is a passive system, no fan.

FIREPLACE & MANTLE

Fireplace

- Model:** Majestic 300DVBNV7 33 direct vent gas fireplace
- Mantle:** Custom Built In Place Mantle (see picture/detail)
- Tile Surround:** 6" Tile Fireplace Surround with 12" Tile Hearth to be full width of fireplace enclosure
- Color:** #Brazil Grey
- Venting:** Direct vent outside wall

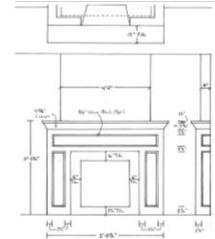

CABINETS & COUNTERTOPS

CABINETS:

All kitchen, bath, and built-in cabinet features:

- Kitchen Cabinets to be Mid Continent Signature Series, Simple Design
- All kitchen cabinets are Concord style in "Natural Maple"
- Pantry Cabinets to be Mid Continent Signature Series, Simple Design
- Pantry cabinets are Concord style in "Natural Maple"
- Vanity Cabinets to be Mid Continent Signature Series, Simple Design
- All vanity cabinets are Concord style in # "Espresso"



Cabinet plans are drawn and presented to the client before cabinet construction begins.
 **Photos are meant to show cabinet style only, actual color may vary

CABINET NOTES: Kitchen Hutch "Built-in" Pantry and Charging Station Cabinet, see kitchen plans for details.

All cabinet pulls/knobs

- Kitchen Knobs #53005-G10
- Bathroom Knobs #53005-G10

COUNTERTOPS:

- Location: Kitchen
- Style: Granite
- Color: #Ubatuba
- Edge Detail: Rounded Edge
- Cut-Outs: Undermount Sink
- Backsplash: Yes
- B/S Location: Back only.



Kitchen Tops

- Location: Master Bathroom 72" vanity
- Style: #International Granite
- Color: #Wheat
- Edge Detail: Square Edge
- Cut-Outs: None
- Backsplash: Yes
- B/S Location: Back only.



Master Bath Top

- Location: Bath #2 60" vanity
- Style: Cultured Marble with integrated bowl
- Color: White with White Bowl
- Edge Detail: Square Edge
- Cut-Outs: None
- Backsplash: Yes
- B/S Location: Back only.

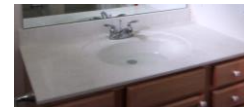

Bath #2 Top

WALL & TRIM INTERIOR DETAIL WORK

INSULATION:

- Type: NGBS Standard
- Exterior walls: R-21- 6" Fiberglass Batts with Poly Vapor Barrier
- Interior Walls: R-13- 3-1/2" Fiberglass Batts for bath and party walls (soundproofing)
- Spray Foam: Box sill in first and second floor joists insulated with closed cell foam.
- Attic: R-50 Cellulose with backer boards at eaves for ventilation.
- Garage: Not insulated.
- Foundation: 2-1/2" R-15 Thermax glued to concrete wall.

DRYWALL:

Living area walls: 1/2" sheet rock, taped with 3 coats of joint compound at walls and ceilings

Party walls: 5/8" sheet rock, taped with 3 coats of joint compound at all common walls between units and common walls between living space and garage

Ceilings: Smooth Finish, minor shadow variations are possible in ceilings.

Garage: 5/8" sheet rock, taped with 1 coat of joint compound at ceiling only

INTERIOR TRIM: "Colonial"

Casing: 3-1/2" Eased Edge with 5/4x4 head casing

Base: 5-1/2" Colonial Base Board

Interior doors:

Make: Masonite
 Model: Masonite Smooth 6 Panel Hollow Core
 Color: #BM Cloud White 967
 Hinges: Satin Nickel



Door Knobs:

Exterior: EZ-Set Keyed Entry w/deadbolt Satin Nickel

Interior: EZ-Set Satin Nickel



Other:

Satin Nickel handrail brackets, hinge bumps and base bumps.

Stairs:

First Floor to Second Floor: Maple Hardwood stairway, treads stained to match Hardwood Flooring
 Box stair construction with half wall and hardwood cap, stained to match stair treads

First Floor to Lower Level: Carpet Grade

Mirrors and Glass:

Mirrors:

Location:
 Master Bath
 Bath #2
 Powder

Details:

Plate Glass mirror with ground edge, no bevel
 Plate Glass mirror with ground edge, no bevel
 By Owner

Shower Curtain Rods Master Bath & Bath #2 Straight Rod.



Wainscot/wall treatment: 36" High Wainscot at Mudroom

Crown: Available as an option

Built-Ins: Coat Pegs at Mudroom

Bath Hardware:

Item:	Quantity	Item #:	Finish
Toilet Paper Holder	3	K-13434	Polished Chrome
Towel Ring	1	K-13435	Polished Chrome
30" Towel Bar	2	K-13432	Polished Chrome
Robe Hook	2	K-13433	Polished Chrome



CLOSET SHELVING:

All closet systems will be vented wire and the system, per the picture here, is indicated on the plan. This includes the pantry.



FLOORING AND PAINT SELECTIONS

FLOORING

Wood Floors

Location: Kitchen, Foyer, Living Room, Dining Room, and Powder Room.
 Make: **#BSL**
 Style: **#Horizon Maple, 4 1/4" width**
 Finish: **#Bronze**



Carpet

Location: Master Bedroom
 Make: Shaw
 Style: **~EA505 Right Away**
 Color: **~510 Cold Water**
 Details:



Location: Bedroom #2, Bedroom #3, and Upstairs Hall
 Make: Shaw
 Style: **#Turn the Page**
 Color: **#Agate 102**
 Details:



Tile

Location: Mudroom
 Maker: **#Marazzi**
 Style: **#Imperial Slate**
 Orientation: Square
 Size: **#12X12**
 Color: **#Black**
 Grout: **#TBD by EPC**



Location: Master Bath
 Maker: **#Anatolia**
 Style: **#Antico**
 Orientation: Square
 Size: **#12X12**
 Color: **#Walnut**
 Grout: **#TBD by EPC**



Vinyl

Location: Bath #2
 Make: **#Tarkett**
 Style:
 Color: **#Mojave Slate FE032**

Location: Laundry Room
 Make: **#Tarkett**
 Style: **#Impresario**
 Color: **#58051**

PAINT:

Exterior Paint:

Exterior Doors: 2 coats of Glidden exterior paint, Front Door Color to be **#BM Webster Green HC-130**.
 Overhead Door: To match siding
 Exterior Lap Siding: D-4 Vinyl Siding, Not Painted
 Trim : Including freeze boards, door surrounds
 Color: White
 Finish: Satin finish
 Windows: Manufacturer's White
 Front Porch: Porch Decking, Rim, and Steps to be stained with TWP Total Wood Preservative, Color to be **#Rustic 1516**. Porch Posts, Rails, and Roof Beam to be White.
 Side Deck: Decking, Rim, and Steps to be stained with TWP Total Wood Preservative, Color to be **#Rustic 1516**. Rails to be White.

Interior Paint:

Paint plan will be developed and approved as selections are made.
 Painted Interior Walls: 1 coat primer with 2 coats of Glidden flat latex paint, Color to be **#BM Alaskan Skies 972**. Low VOC Interior paint to be used
 Accent Wall Color: Optional
 Ceilings: To Match Walls
 Interior Trim, painted: Painted, 1 primer, 2 coats of semi-gloss latex paint
 Color: **#BM Cloud White 967**
 Interior Doors: Color: **#BM Cloud White 967**
 Semi-Gloss finish
 Interior Trim, stained: N/A

APPLIANCES

APPLIANCES:

Kitchen

Refrigerator

Make: Whirlpool
Model: #WRF535SMBB
Color: Black
Options: #French Door



Gas Range

Make: Whirlpool
Model: WFG540H0AB
Color: Black
Features:

Dishwasher

Make: Whirlpool
Model: WDT720PADB
Color: Black
Features:



Microwave

Make: Whirlpool
Model: WMH73521CB
Color: Black
Features: 2.1 cu. Ft.
Location: Located over Range.

Laundry

Washer Available as an Option
Model
Color
Details

Dryer Available as an Option
Model
Color
Details

LANDSCAPING

LANDSCAPING:

All disturbed portions of yard to be seeded. Lawn area will generally include front yard, side yard, and rear yard. Lawn area to be covered with approximately 4" of native topsoil. Landscaping of this home includes six foundation shrubs, six perennial flowers and two small yard trees.

SITE WORK AND PREPARATION

SITE CLEARING:

Builder is responsible for all site clearing, as needed.

EXCAVATION & FILL:

Builder responsible for all site work and site balance to include:

- * Connection to City of South Burlington water and sewer systems
- * Connection to natural gas lines at road. Underground power, fiber optic telephone and cable TV in conduit to house
- * 12" thick gravel two car driveway on top of mirafi fabric. Driveway to be finish paved with 2" of compacted asphalt
- * Footing drains installed around Lower Level and drained to daylight in back yard. Drain tile buried in clean 1" stone; covered with mirafi fabric; clean sand fill from fabric to 12" below grade. Site graded to shed surface water away from house
- * Boulder rock walls as needed for the grading of the yard. Boulders from the site are machine-placed to create walls.
- * 42" wide brick walkway from front porch to sidewalk.
- * Yards, shrubs, landscaping and snow removal are maintained by the South Village Homeowners Association. Owner can plant additional plantings around their home.

MISCELLANEOUS

CLEANING:

House cleaned prior to closing, including washing of windows.

ENERGY PACKAGE:

Home to be built to an Energy Code Plus rating and certified green through the National Green Building Standard. Home to include:

- 1) 110 CFM fan to exhaust air from the house in Master Bath and Bath #2 controlled by a programmable 24-hour timer.
- 2) Programmable setback thermostat on each heating zone.
- 3) Additional caulking and sealing of joists to reduce air infiltration into the home, including shoe plate; windows; and where wires and pipes go to cold spaces.
- 4) Lower Level insulation on the interior using rigid "Thermax" insulation to be located from the floor to the top of concrete wall to comply with Efficiency Vermont standards.
- 5) Selected use of closed cell foam to improve overall air sealing of home.
- 6) Pre-drywall and diagnostic testing after the house is complete by Efficiency VT to verify satisfaction of Energy Code Plus performance Requirements

WARRANTY:

SCI Warrantee as per contract.

Continuing a policy of constant research and improvement, South Village Communities, LLC reserves the right to make substitutions and specification changes.

SIGNATURES:

Client: _____

Date _____

Client: _____

Date _____

Collin Frisbie, Builder
For: Sterling Construction Inc.

Date _____